

EALING BROADWAY STATION ENTRANCE

PROJECT BACKGROUND

This station is used by over 20 million people a year, both as a gateway to Ealing Broadway – one of 13 metropolitan town centres in London – and also as a key interchange between the Central and District lines, and National Rail. When Crossrail opens in 2020 the number of people using the station will jump even higher, and we need to make sure that the surrounding streets can cope.

VISION FOR PUBLIC REALM

The public realm proposal for the station entrance will massively improve the character of the area, while providing a distinctive new civic space that will cope with this uplift in visitor numbers.

As people on foot outnumber vehicles on The Broadway by nearly four to one, the pedestrian experience is at the heart of this proposal – for the sake of safety, comfort and to provide a good impression of this key gateway to the borough. New seating, wider footways, additional trees and a new signalised pedestrian crossing will help to welcome people to Ealing Broadway.

DESIGN STRATEGY

- Provide for busy pedestrian flows by widening footways where possible
- Make getting around easier with new pedestrian crossings
- Add to the existing character of Haven Green by protecting existing trees, and providing new trees where possible
- Carefully position street furniture to minimise impact on pedestrian flows
- Choose materials that tie in with the existing high-quality paving on surrounding footways
- Include cycle parking near the station entrance, to enable more sustainable travel
- Avoid high maintenance costs in the future by designing for durability

Find out more:

More information about the scheme is available on our website at: <http://www.ealing.gov.uk/ebstation>

What happens next?

We'd love to get your feedback. Please complete the online survey on the scheme website, and your comments will be collated and considered. Any necessary changes will be made as part of the detailed design

Contact us:

If you have any queries please email: ealingbroadwaypublicrealm@wsp.com

LANDSCAPE MASTERPLAN - 1:500

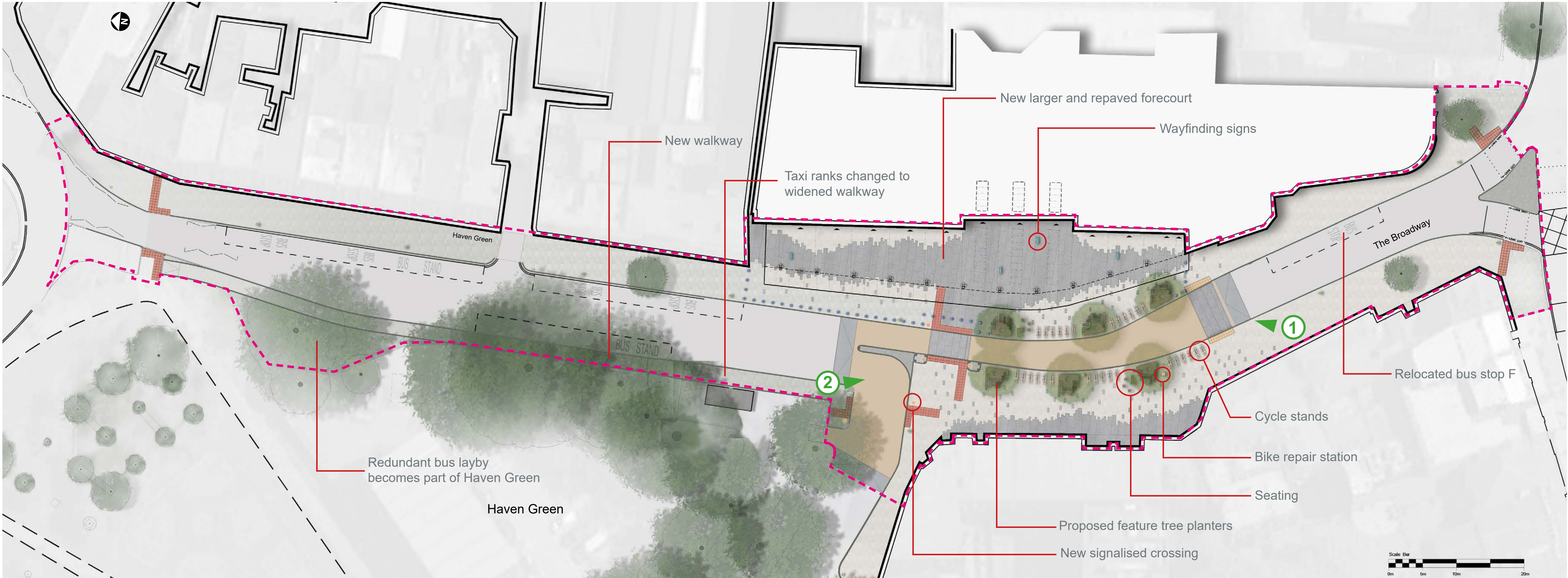

VIEW 1



Tree canopy to provide shade in summer.

Flush pedestrian crossing to provide inclusive access to the Station.

Cycle parking provided closer to station entrance, to encourage multi-modal transport

Pump provided to assist with unexpected cycle maintenance

VIEW 2



Wayfinding signage at station entrance to assist people navigate.

Raised planters incorporated seating steps, help to define vehicular space.

Coloured asphalt with reduced kerb upstand to give a stronger pedestrian priority and calm vehicular traffic.