

MARKET OPERATOR APPLICATION FORM

Personal Details

Contact Name	
Contact Telephone/Mobile	
Contact email address	
Company Name	
Company Address	
Company Registration Number	
VAT Registration number (if applicable)	

Market description

[Please provide a description of your proposed market. Include why your market is unique and a summary of what you are selling]

MARKET OPERATOR APPLICATION FORM

Market experience

[Please provide more information on your market management experience. Include the type/s, locations, how many and time period managed. Please also provide photographs of the markets you have previously managed]

MARKET OPERATOR APPLICATION FORM

How do you think your market will benefit Southall?

How would you publicise your market?

[What are your methods of communication to the public? Do you use social media? Please provide examples of previous communication methods]

Based on the site plan, how do you plan to lay your market out? (you may draw the layout over the site plan provided if you prefer)

[Refer to plan attached]

MARKET OPERATOR APPLICATION FORM

Please provide a description of your stall structure, awnings and breakdown of individual stall make up. please provide PICTURES (e.g number of artisan stalls, number of craft stalls)

What are your proposed dates and operation times for you market? (Including set up/set down times)

How do you plan to manage your waste and litter? please submit your waste management plan

MARKET OPERATOR APPLICATION FORM

Can you provide details of licenses (e.g. food related license) for all your traders and the insurances you hold (please provide documentation)

Please provide your health and safety risk assessment

Please provide your traffic management and loading/unloading plan for this site

MARKET OPERATOR APPLICATION FORM

Ealing Council is looking to activate the space at Southall Square. The market will not be used as a profit-generating service for the Council, but a regeneration project that will help revitalise and improve the profile of the town centre. However, the Council will still look to generate an annual rent that will be reinvested back into the area.

1. Please fill in the below table to indicate the rent that you are prepared to pay.
2. The total figure for the combined years will be used to evaluate your submission.
3. The Council will not expect rent for the first two months

<u>MONTH</u>	<u>PROPOSED MONTHLY RENT</u> £
MONTH 1	The Authority does not expect rent in month one (1).
MONTH 2	The Authority does not expect rent in month two (2).
MONTH 3	
MONTH 4	
MONTH 5	
MONTH 6	
MONTHS 7-12	
MONTHS 13-24	
MONTHS 25-36	
TOTAL	

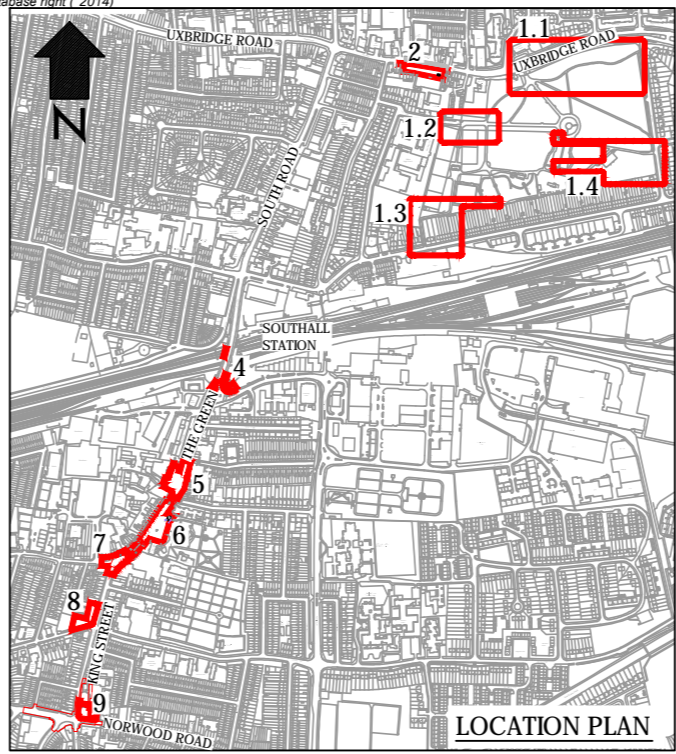
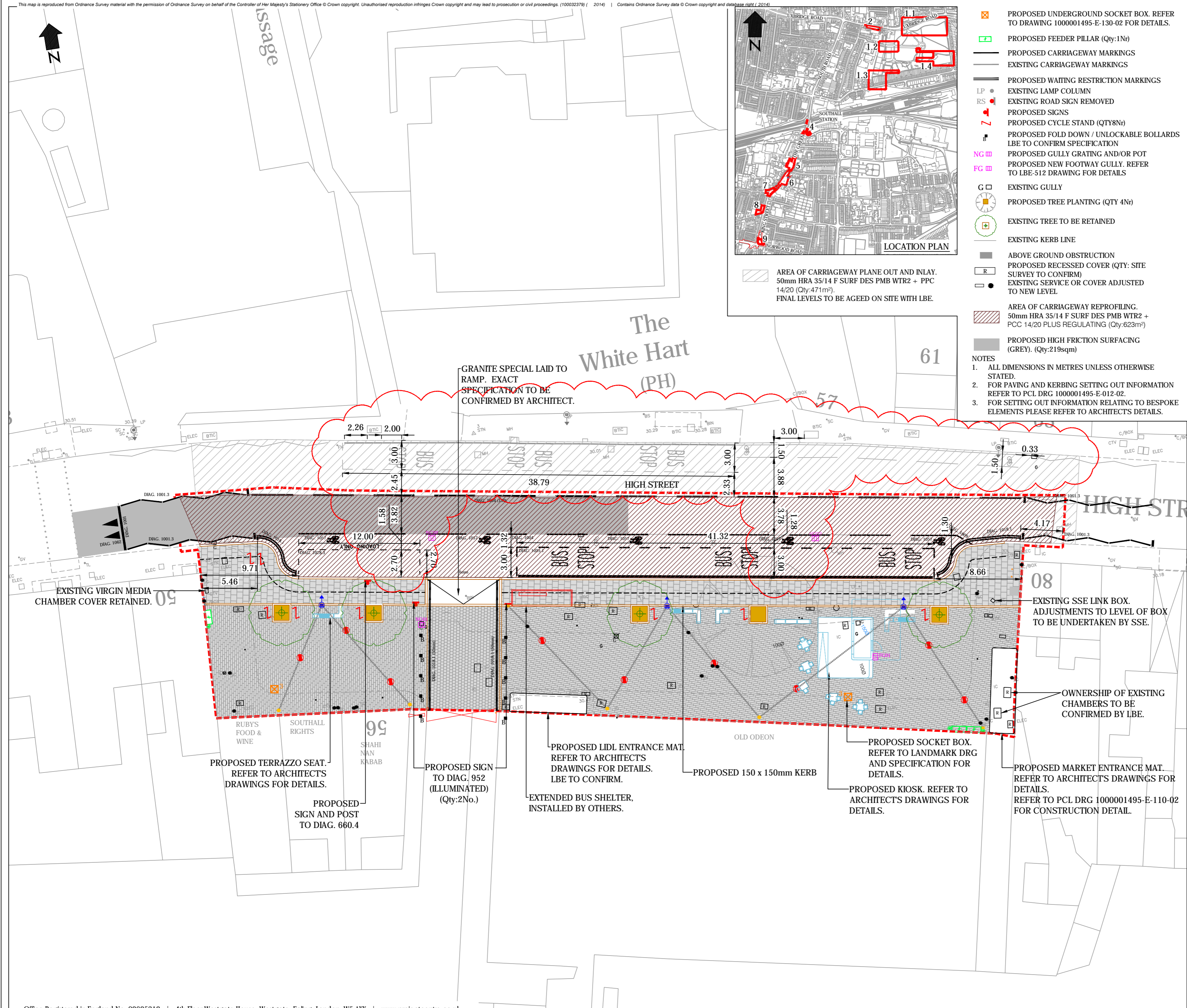

AREA OF CARRIAGEWAY PLANE OUT AND INLAY.
50mm HRA 35/14 F SURF DES PMB WTR2 + PPC
14/20 (Qty:471m²).
FINAL LEVELS TO BE AGED ON SITE WITH LBE.

- PROPOSED UNDERGROUND SOCKET BOX. REFER TO DRAWING 1000001495-E-130-02 FOR DETAILS.
- PROPOSED FEEDER PILLAR (Qty:1Nt)
- PROPOSED CARRIAGEWAY MARKINGS
- EXISTING CARRIAGEWAY MARKINGS
- PROPOSED WAITING RESTRICTION MARKINGS
- EXISTING LAMP COLUMN
- EXISTING ROAD SIGN REMOVED
- PROPOSED SIGNS
- PROPOSED CYCLE STAND (QTY:8Nt)
- PROPOSED FOLD DOWN / UNLOCKABLE BOLLARDS LBE TO CONFIRM SPECIFICATION
- PROPOSED GULLY GRATING AND/OR POT
- PROPOSED NEW FOOTWAY GULLY. REFER TO LBE-512 DRAWING FOR DETAILS
- EXISTING GULLY
- PROPOSED TREE PLANTING (QTY 4Nt)
- EXISTING TREE TO BE RETAINED
- EXISTING KERB LINE
- ABOVE GROUND OBSTRUCTION
- PROPOSED RECESSED COVER (QTY: SITE SURVEY TO CONFIRM)
- EXISTING SERVICE OR COVER ADJUSTED TO NEW LEVEL
- AREA OF CARRIAGEWAY REPROFILING.
50mm HRA 35/14 F SURF DES PMB WTR2 + PCC 14/20 PLUS REGULATING (Qty:623m²)
- PROPOSED HIGH FRICTION SURFACING (GREY). (Qty:219sqm)

- NOTES
- ALL DIMENSIONS IN METRES UNLESS OTHERWISE STATED.
 - FOR PAVING AND KERBING SETTING OUT INFORMATION REFER TO PCL DRG 1000001495-E-012-02.
 - FOR SETTING OUT INFORMATION RELATING TO BESPOKE ELEMENTS PLEASE REFER TO ARCHITECT'S DETAILS.

LEGEND

- LIMIT OF MAJOR WORKS
- PROPOSED FOOTWAY PAVING
600 x 600 x 60mm ROYAL WHITE FLAME TEXTURED GRANITE AND 300 x 600 x 60mm SLAB EVERY 5th COURSE
30mm BEDDING LAYER (3:1 SAND/CEMENT)
100/150mm CONCRETE ST3 BASE
100mm TYPE 1 SUB BASE (Qty: 231m²).
- EXTENT OF 1500mm WIDE VEHICLE OVERRUN ZONE AND 150mm CONCRETE BASE.
- PROPOSED PUBLIC SPACE PAVING 210 x 600 x 80mm MID GREY FLAME TEXTURED GRANITE SETTS
30mm BEDDING LAYER (3:1 SAND/CEMENT)
150mm CBM1A BASE/EXISTING CONCRETE BASE. REFER TO PCL DRG 1000001495-E-110-02 FOR DETAILS (Qty: 727m²).
- PROPOSED VEHICULAR ACCESS PAVING 300 x 300 x 80mm MID GREY FLAME TEXTURED GRANITE SETTS.
30mm BEDDING LAYER (STEINTEC TUFFSET G)
150mm FIBRE REINFORCED CONCRETE BASE (Qty: 74m²).
- PROPOSED TERRAZZO CLAD STRUCTURE. REFER TO ARCHITECT'S DRAWINGS FOR DETAILS.
- TREE PIT CONSTRUCTION. REFER TO PCL DRG 10000001495-F-300-01 & 02 FOR DETAILS (QTY:5Nt)
- PROPOSED 200mm WIDE GRANITE KERB, VARIOUS UPSTANDS. REFER TO PCL DRG 1000001495-E-012-02 FOR DETAILS.
- RELOCATED STREET LIGHTING COLUMN (Qty:3)
- PROPOSED CATENARY LIGHTING POSTS (Qty:6)
- PROPOSED CATENARY LIGHTING. REFER TO LIGHTING DRAWING 1000001495-E-130-02 FOR DETAILS.

Rev	Date	Description	Dm	Chk	App
3	01/07/2014	DIMENSIONS OF EXISTING RD-MARKINGS SHOWN AS PER CLIENT REQUEST	AD	TM	MC
2	29/05/2014	ADDITIONAL SURFACING WORKS ADDED	AD	TM	TM
1	21/05/2014	LIGHTING AND KERBING REVISED LEGEND AND NOTES AMENED	MG	TM	TM
0	14/04/2014	CONSTRUCTION ISSUE	AD	TM	MC

This drawing has been specifically prepared to meet the requirements of the named client and may contain design and innovative features which differ from conventional design standards.

PROJECT CENTRE



4th Floor, Westgate House
Westgate, Ealing,
London W5 1YY
Tel: + 44 (0)20-7421-8222
Fax: + 44 (0)20-7421-8199
Email: info@projectcentre.co.uk

Client



Project

SOUTHALL GREAT SPACES
PHASE 2

Drawing Title

SITE 2
THE OLD ODEON
GENERAL ARRANGEMENT

Drawing Status

FOR CONSTRUCTION

Drawn	Designed	Date	Scale	Size
AD	TM	10/04/2014	1:250	A2

Drawing No.	Rev
1000001495-E-010 -02	3